



Fixing type

Plain bores for fixing with bolts from above.

Material

Reinforced nylon (15% glass filled PA6)

Standard handle colour

Black

Finish

Matt

Thread

Moulded bore

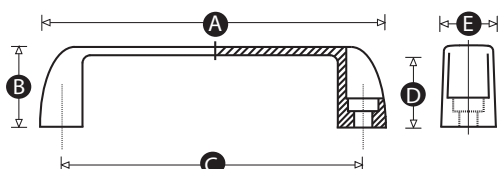

Part No.	A	B	C	D	E	Bore size (mm)
11122W	111	35	94	29	22	6.5
11123S	140	41	117	34	26	8.5
11124Z	154	45	132	38	27	8.5
11125V	205	50	179	43	31	8.5
11126R	250	50	225	43	31	8.5