

**Handle material**

Reinforced nylon (15% glass filled PA6)

**Insert material**

Blackened steel boss and ratchet with allen key fixing screw.  
Stainless steel boss on request (MOQs apply).

**Handle colours**

Black handle as standard. Other RAL colours on request (MOQs apply).

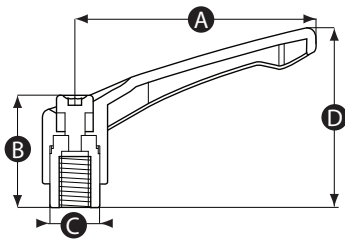

Part No.	A	B	C	D	Thread size
12661P	42	25	10	38	M5
12662W	42	25	10	38	M6
12663S	65	31	14	50	M6
12664Z	65	31	14	50	M8
12665V	83	36	16	60	M8
12666R	83	36	16	60	M10
12668U	83	36	16	60	M12