

**HD**

**Material**

Aluminium

**Finish**

Highly polished

**Thread**

Machined thread

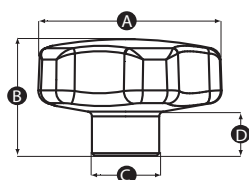

Part No.	A	B	C	D	Thread size
12702Q	40	24	14	8	M6
12703X	40	24	14	8	M8
12705P	50	31	18	10	M8
12704T	50	31	18	10	M10
12706W	60	39	20	14	M10
12707S	60	39	20	14	M12