



**Material**

Die cast zinc

**Pin material**

Stainless steel 304 or nickel plated steel

**Finish**

Powder coated

**Colour**

Black

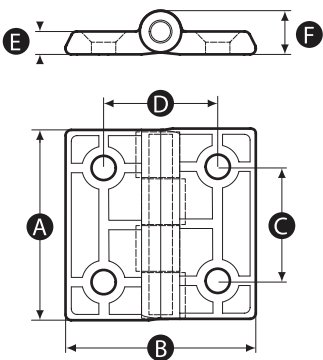

Part No.	A	B	C	D	E	F	Bore size (mm)	Pin material
15765W	40	40	25	25	5	10	5.2	SS304
15750Q	50	50	30	30	6	12	6.4	Nickel plated steel

Part No.	Radial load (N)	Axial load (N)	Recommended tightening torque (Nm)	Approx. shear force per screw (kN)
15765W	1250	2100	1.5	0.28
15750Q	1300	2200	2.5	0.5