

**Material**

Duroplast

**Standard colour**

Black

**Finish**

Gloss

**Female thread**

Moulded

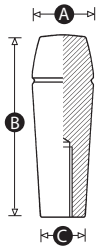

Part No.	A	B	C	Thread size
8272P	18	40	12	M6
1366P	18	40	12	M8
4129Q	20	60	14	M6
1375W	20	60	14	M8
1391Y	24	80	18	M6
1392U	24	80	18	M8
1408W	28	95	20	M8
8274S	28	95	20	M10
1407P	28	95	20	M12
1426Q	30	110	22	M10
8275Z	30	110	22	M12